

No guarantee can be given in respect of this translation
In all cases the latest German-language version of this standard shall be taken as authoritative

Plain Washers
for Bolts with Heavy Clamping Sleeves

DIN
7349

Scheiben für Schrauben mit schweren Spannhülzen

Dimensions in mm

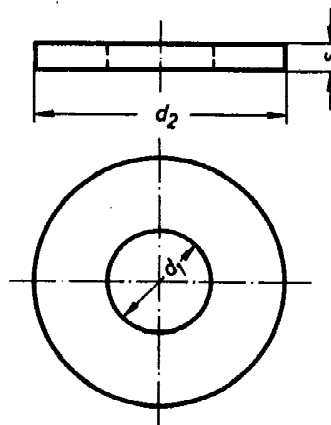

Designation of a plain washer with hole diameter $d_1 = 17$ mm in steel (St):
Plain washer 17 DIN 7349 - St

d_1	d_2	s	Weight (7,85 kg/dm ³) kg/1000 pieces ≈	For clamping sleeves according to DIN 1481 Nominal diameter	For thread diameter
3,2	9	1	0,436	6	3
4,3	12	1,6	1,24	8	4
5,3	15	2	2,43	10	5
6,4	17	3	4,59	12	6
8,4	21	4	9,15	16	8
10,5	25	4	12,7	18	10
13	30	6	27,1	21	12
15	36	6	39,6	25	14
17	40	6	48,5	28	16
19	44	8	77,4	32	18
21	44	8	73,4	35	20
23	50	8	97,1	38	22
25	50	10	116	40	24
28	60	10	174	45	27
31	68	10	226	50	30

Technical conditions of delivery according to DIN 522

Material: St = steel; grade at manufacturer's choice

Other materials or special strength properties subject to agreement

Type: m according to DIN 522

For heavy clamping sleeves, see DIN 1481

Translation
Fachtechnisches Übersetzungsinstitut
Henry G. Freeman, Düsseldorf

Alleinverkauf der Normblätter durch Beuth Verlag GmbH, Berlin 30 und Köln

DIN 7349 engl. Preisgr. 4